

NOTES: (UNLESS OTHERWISE SPECIFIED)

1. Interface comply with IEC 169-15.
 2. Part must be packaged to avoid any damaged during transportation.
- ⚠ After crimping dimension should be AF/SW 5.41.

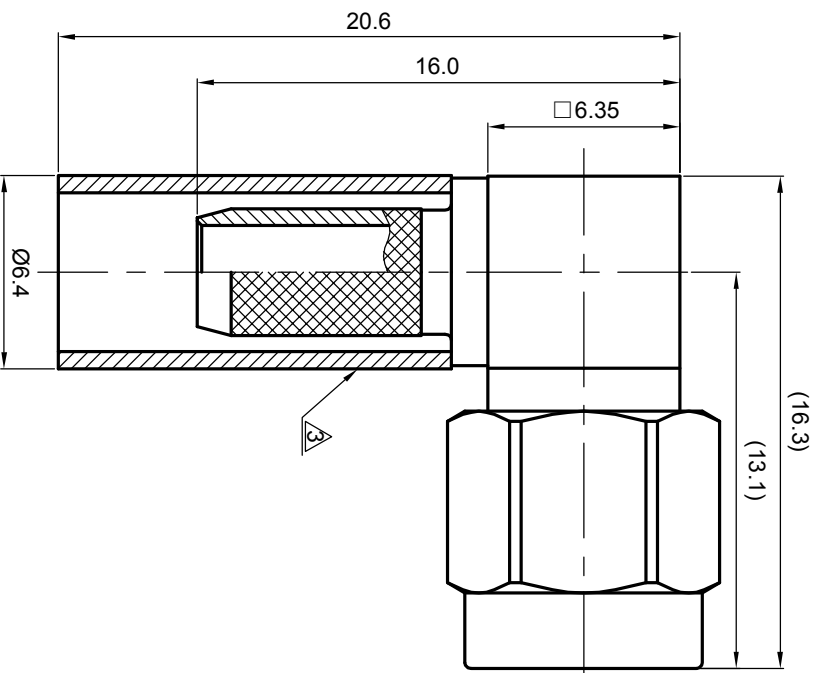
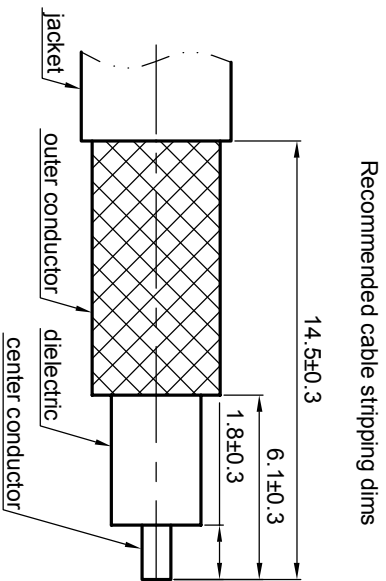

REV.	DESCRIPTION	APPROVED	DATE	EON
A	REL. TO PRODUCTION	Johnny	21 Nov 07	

MATERIAL		TOLERANCES		THIRD ANGLE PROJECTION		TITLE	
SEE BOM OF DETAILS		Opface X ±1 1place .X ±0.1 2place .XX ±0.05 Angle ±5°				Zeeteq	
FINISH		Remove burrs and sharp edges		GENERAL ECCENTRICITY		DWG NO. 5013.SMA.PRC.08.111	
SEE BOM OF DETAILS				<input checked="" type="checkbox"/> 0.06		SMA, plug, cable	
Plating part to be touched by gloves		-0.2 +0.2		DRAWN BY		DATED 20 Nov 07	
Dimension apply before plating				CHECKED BY		DATED 21 Nov 07	
XXX - measuring point for plating				APPROVED BY		DATED 21 Nov 07	
SURFACE		VOLUME		NOTICE: Those drawings and specifications are the property of ZEETEQ CORPORATION and used only for the specify purpose authorised by ZEETEQ		SCALE 4:1	
						DO NOT SCALE DRAWING	
						SIZE A4	
						SHEET 1 of 1	

1.6