

NOTES: (UNLESS OTHERWISE SPECIFIED)

1. After crimping dimension should be AF/SW 3.25

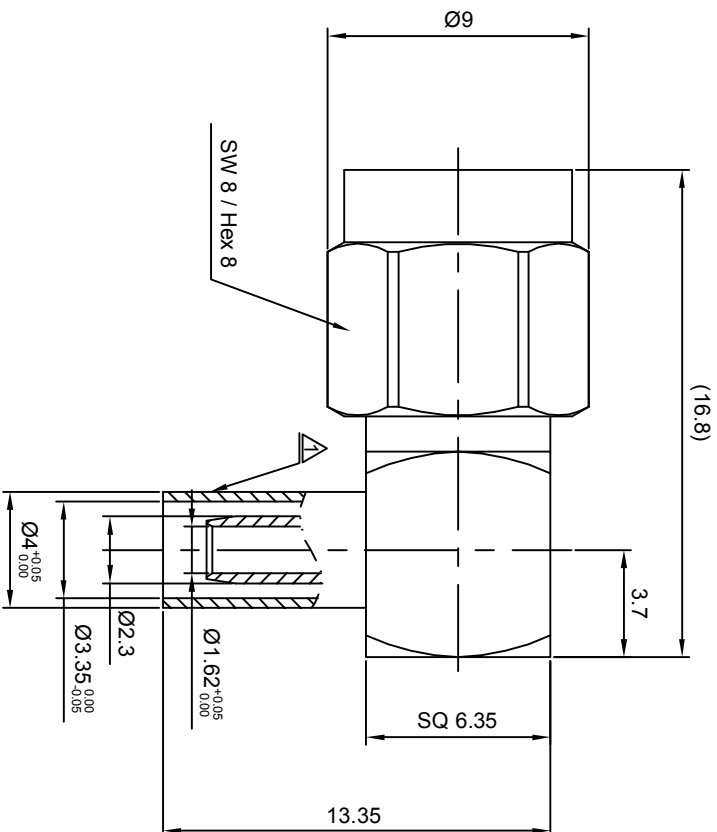

recommended cable stripping dims

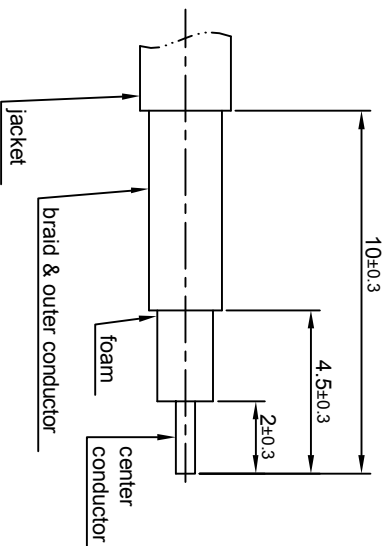

REV.	DESCRIPTION	APPROVED	DATE	ECN
A	REL TO PRODUCTION	Johnny	15Nov07	

MATERIAL SEE BOM		TOLERANCES		THIRD ANGLE PROJECTION		TITLE	
FINISH SEE BOM		Remove burrs and sharp edges					
Plating part to be touched by gloves		Opface X ±1		DRAWN BY Collin		DWG. NO. 5012.SMA.PRC.07.111	
Dimension apply before plating		Iplace X ±0.1		CHECKED BY Danny		SCALE 4:1	
XXX - measuring point for plating		Zplace XX ±0.05		APPROVED BY Johnny		DO NOT SCALE DRAWING	
SURFACE		Angle ±5°		DATE 15Nov07		SIZE A4	
VOLUME		Remove burrs and sharp edges		DATE 15Nov07		SHEET 1 of 1	
						REV. A	

NOTICE: Those drawings and specifications are the property of ZEETEQ CORPORATION and used only for the specify purpose authorised by ZEETEQ

