

NOTES: (UNLESS OTHERWISE SPECIFIED)

1. The interface comply with IEC169-10.
2. After crimping dimension should be SW2.67
3. Part must be packaged to avoid any damages during transportation.

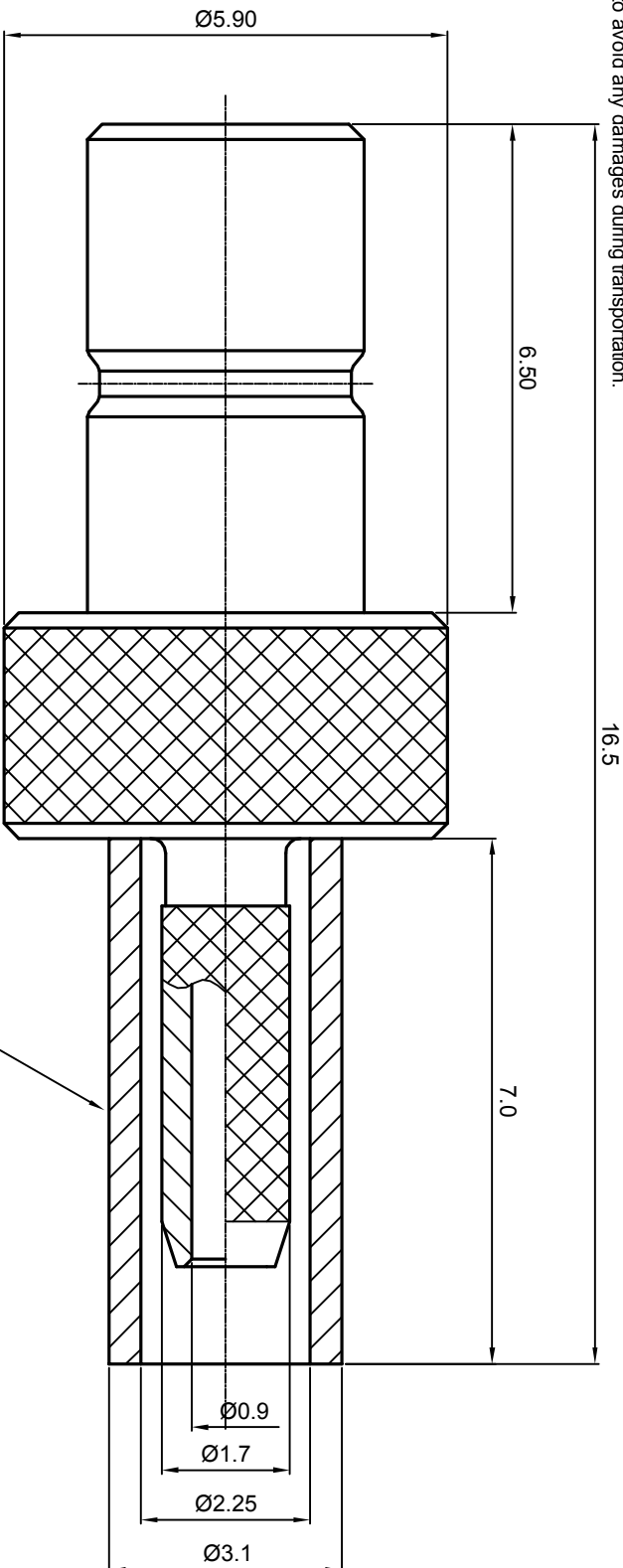

RECOMMENDED CABLE
STRIPPING DIMENSIONS

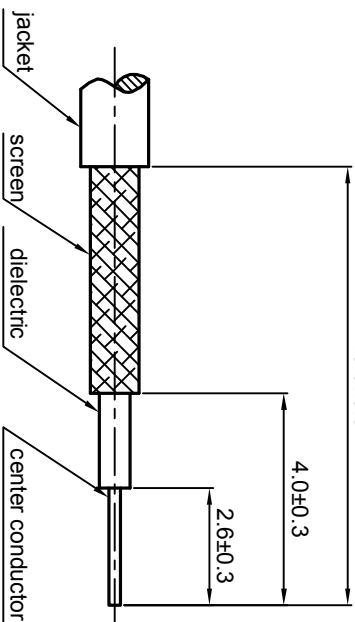

REV.	DESCRIPTION	APPROVED	DATE	EON

MATERIAL		TOLERANCES		THIRD ANGLE PROJECTION		TITLE	
SEE BOM FOR DETAILS		0place X ±1	1place X ±0.1			Zee-teq	
SEE BOM FOR DETAILS		2place XX ±0.05	Angle ±5°	GENERAL ECCENTRICITY <input checked="" type="checkbox"/> 0.06		SMB, PLUG, CABLE	
FINISH		Remove burrs and sharp edges		DRAWN BY Danny 08NOV07		DWG. NO. 5139.SMB.PSC.05.111	
Plating part to be touched by gloves				CHECKED BY		REV. S1	
Dimension apply before plating		NOTICE: Those drawings and specifications are the property of ZEE-TEQ CORPORATION and used only for the specify purpose authorised by ZEE-TEQ		APPROVED BY		SCALE 10:1	
XXX - measuring point for plating						DO NOT SCALE DRAWING	
SURFACE						SIZE A4	
VOLUME						SHEET 1 of 1	

1.6