

NOTES: (UNLESS OTHERWISE SPECIFIED)

1. The interface comply with CECC 22340.
2. Part must be packaged to avoid any damaged during transportation.
3. After crimping dimension should be AFSW 3.25.

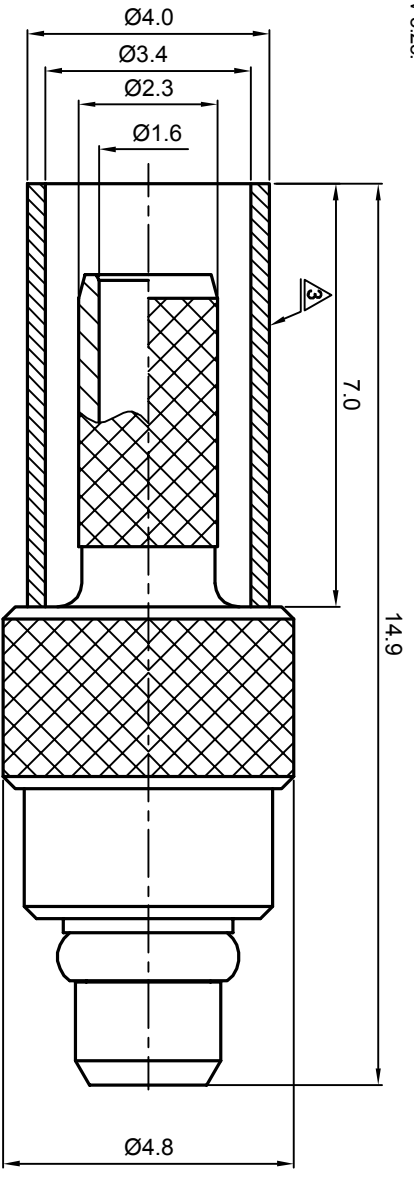

RECOMMENDED CABLE
STRIPPING DIMENSIONS
11.5±0.3

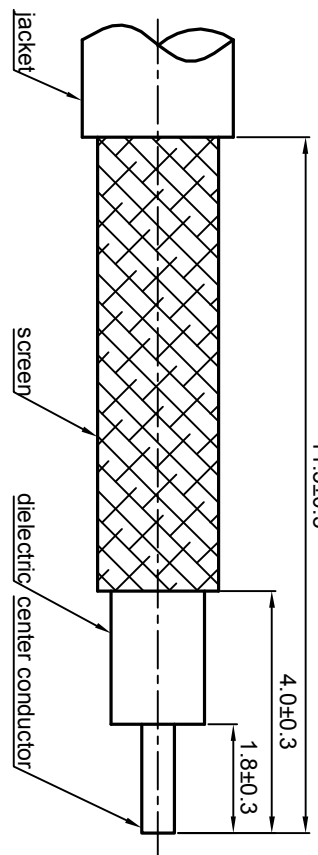

REV.	DESCRIPTION	APPROVED	DATE	EON

MATERIAL SEE BOM FOR DETAILS		TOLERANCES Oplace X ±1 1place X ±0.1 2place XX ±0.05 Angle ±5°		THIRD ANGLE PROJECTION 		TITLE Zeeteq	
FINISH SEE BOM FOR DETAILS		Remove burrs and sharp edges 		GENERAL ECCENTRICITY 0.06		DWG. NO. 5122.MMCX.PSC.07.111	
Plating part to be touched by gloves		DRAWN BY Danny		NAME DATE		REV. S1	
Dimension apply before plating		CHECKED BY		DATE 05NOV07			
XXX - measuring point for plating		APPROVED BY					
SURFACE		VOLUME		NOTICE: Those drawings and specifications are the property of ZEETEQ CORPORATION and used only for the specify purpose authorised by ZEETEQ		SCALE 8:1	
						DO NOT SCALE DRAWING	
						SIZE A4	
						SHEET 1 of 1	