

NOTES: (UNLESS OTHERWISE SPECIFIED)

1. The interface comply with CECC 22340.
 2. Part must be packaged to avoid any damaged during transportation.
- ⚠ After crimping dimension should be AF/SW 2.67.

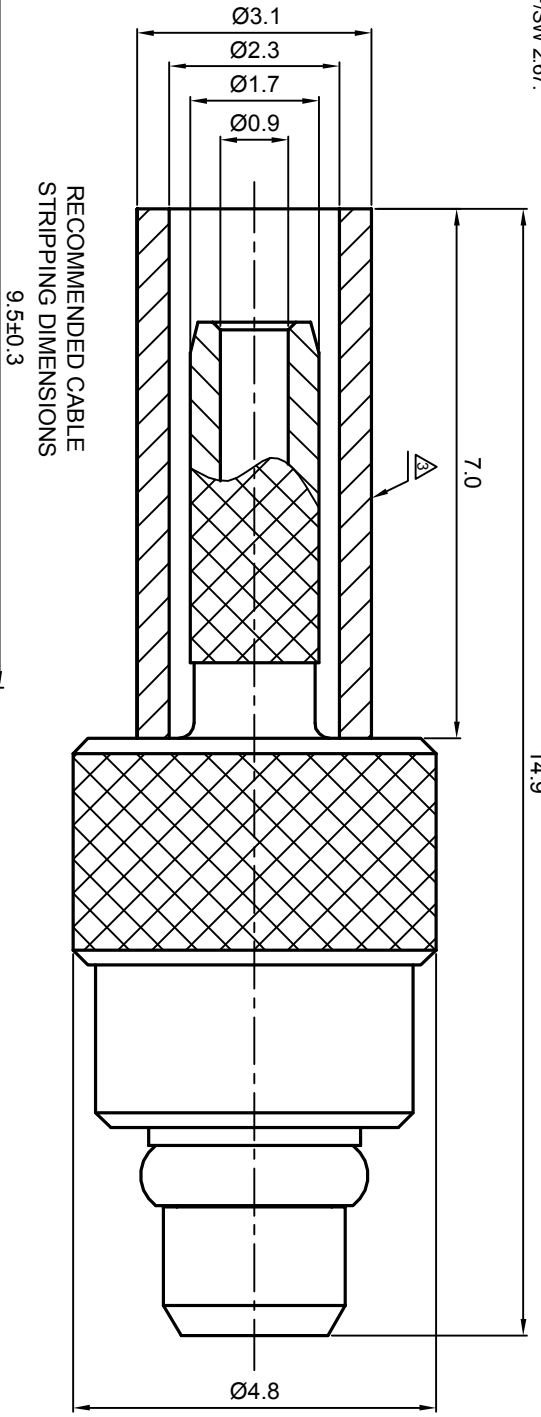

RECOMMENDED CABLE STRIPPING DIMENSIONS

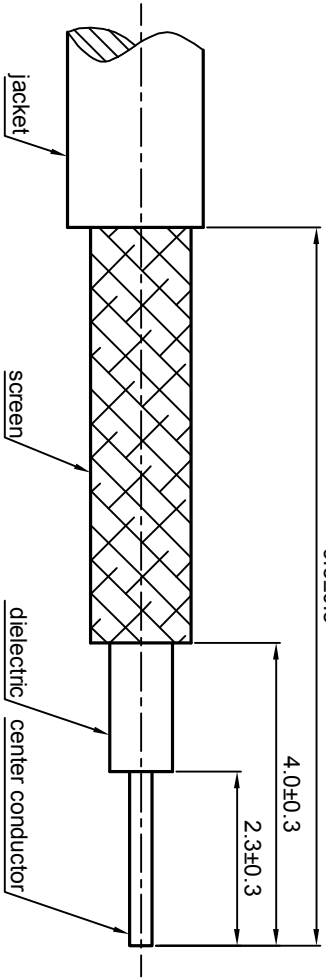

REV.	DESCRIPTION	APPROVED	DATE	EON

MATERIAL SEE BOM FOR DETAILS		TOLERANCES Oplace X ±1 1place X ±0.1 2place XX ±0.05 Angle ±5°		THIRD ANGLE PROJECTION 		TITLE Zee-teq	
FINISH SEE BOM FOR DETAILS		Remove burrs and sharp edges 		GENERAL ECCENTRICITY 0.06		DWG. NO. 5120.MMCX.PSC.05.111	
Plating part to be touched by gloves		DRAWN BY Danny		NAME Danny		DATE 05NOV07	
Dimension apply before plating		CHECKED BY		APPROVED BY		REV. S1	
XXX - measuring point for plating		SURFACE		VOLUME		SCALE 10:1	
						DO NOT SCALE DRAWING	
						SIZE A4	
						SHEET 1 of 1	

MMCX, PLUG, CABLE

5120.MMCX.PSC.05.111