

NOTES: (UNLESS OTHERWISE SPECIFIED)

1. Interface comply with IEC 169-16.
 2. Part must be packaged to avoid any damaged during transportation.
- A** After crimping dimension should be AF/SW 10.90.

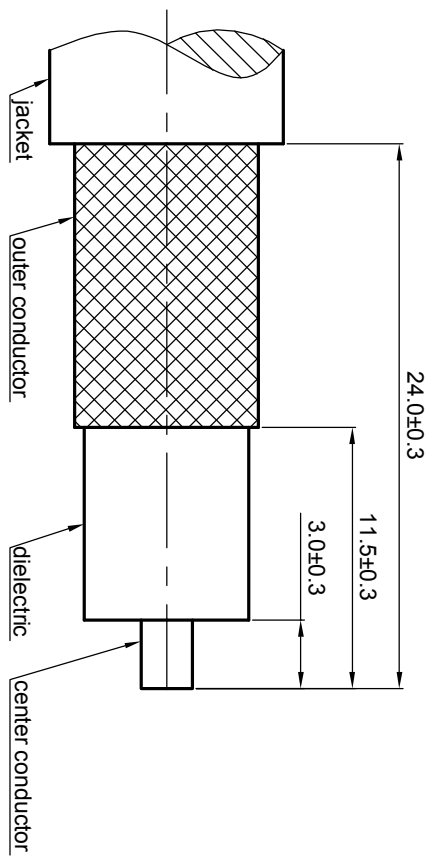
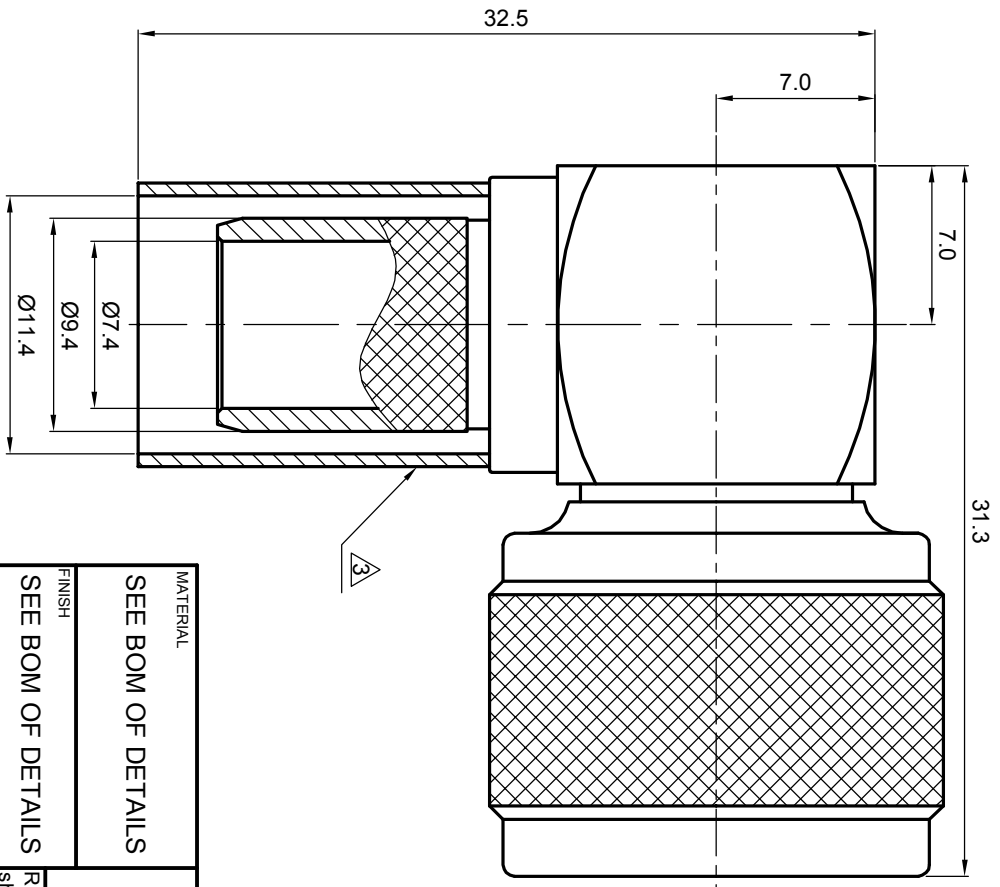

RECOMMENDED CABLE STRIPPING DIMENSIONS

REV.	DESCRIPTION	APPROVED	DATE	EON
A	REL TO PRODUCTION	Johnny	18Jul08	ECN_08_034

MATERIAL		SEE BOM OF DETAILS		TOLERANCES		THIRD ANGLE PROJECTION		TITLE	
SEE BOM OF DETAILS		SEE BOM OF DETAILS		Opface X ±1 1place .X ±0.1 2place .XX ±0.05 Angle ±5°				Zee-teq	
FINISH		Remove burrs and sharp edges		-0.2 +0.2		GENERAL ECCENTRICITY <input checked="" type="checkbox"/> 0.06		N, plug, cable	
SEE BOM OF DETAILS		Plating part to be touched by gloves		DRAWN BY		NAME		DATE	
Dimension apply before plating		Plating part to be touched by gloves		Danny D		Danny D		22Nov07	
XXX - measuring point for plating		Dimension apply before plating		CHECKED BY		APPROVED BY		DWG NO.	
SURFACE		VOLUME		NOTICE: Those drawings and specifications are the property of ZEE-TEQ CORPORATION and used only for the specify purpose authorised by ZEE-TEQ		SCALE		5054.N.PRC.12.133	
						3:1		DO NOT SCALE DRAWING	
						A4		SIZE	
						1 of 1		SHEET	
						A		REV.	

