

NOTES: (UNLESS OTHERWISE SPECIFIED)

- 1. The interface comply with IEC169-16.
- 2. After crimping dimension should be SW3.25
- 3. Part must be packaged to avoid any damaged during transportation.

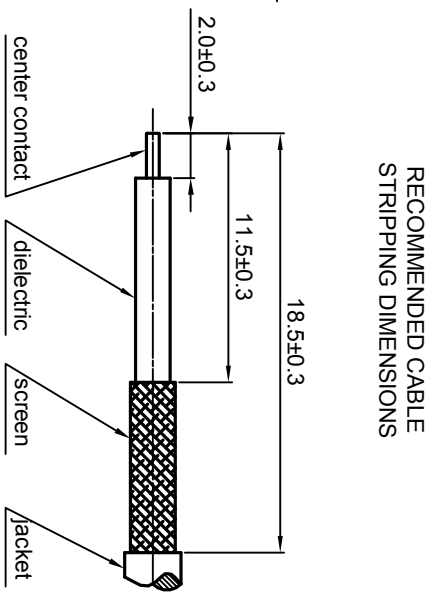
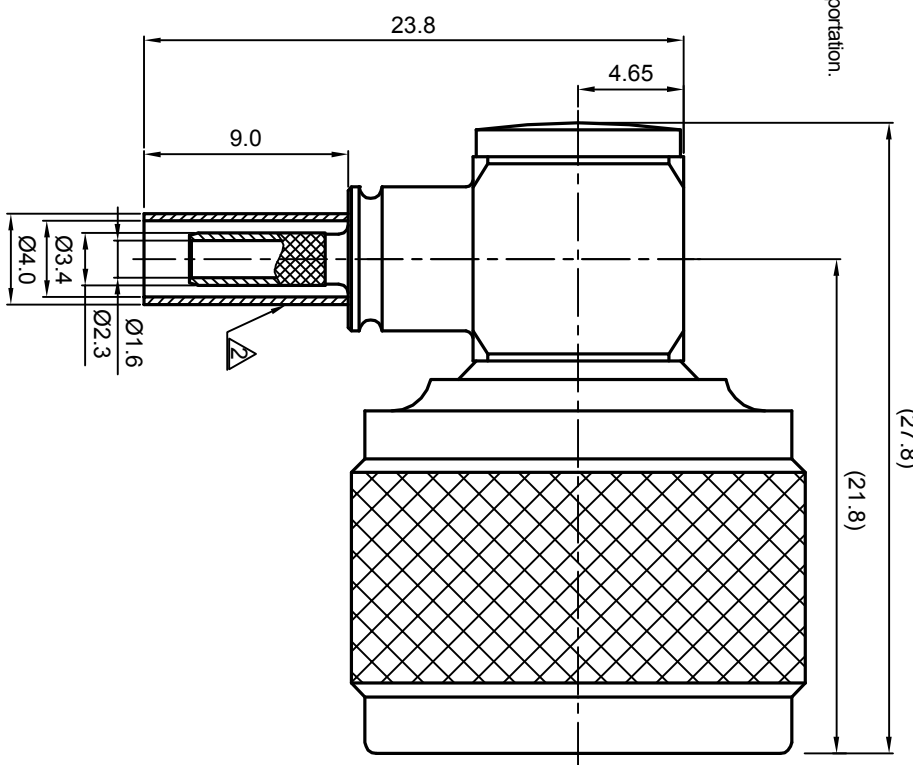

REV.	DESCRIPTION	APPROVED	DATE	EON

RECOMMENDED CABLE STRIPPING DIMENSIONS

1.6

MATERIAL SEE BOM FOR DETAILS		TOLERANCES Oplace X ±1 1place X ±0.1 2place XX ±0.05 Angle ±5°		THIRD ANGLE PROJECTION 		TITLE N, PLUG, CABLE MOUNT	
FINISH SEE BOM FOR DETAILS		Remove burrs and sharp edges 		GENERAL ECCENTRICITY <input checked="" type="checkbox"/> 0.06		DWG. NO. 5049.N.PRC.07.133	
Plating part to be touched by gloves		DRAWN BY Danny.D		NAME DATE		REV. S1	
Dimension apply before plating		CHECKED BY		APPROVED BY		SCALE 3:1	
XXX - measuring point for plating		NOTICE: Those drawings and specifications are the property of ZEETEQ CORPORATION and used only for the specify purpose authorised by ZEETEQ		DO NOT SCALE DRAWING		SIZE A4	
SURFACE		VOLUME				SHEET 1 of 1	