

NOTES: (UNLESS OTHERWISE SPECIFIED)

- 1. The interface comply with IEC169-16.
- 2. After crimping dimension should be SW3.25
- 3. Part must be packaged to avoid any damaged during transportation.

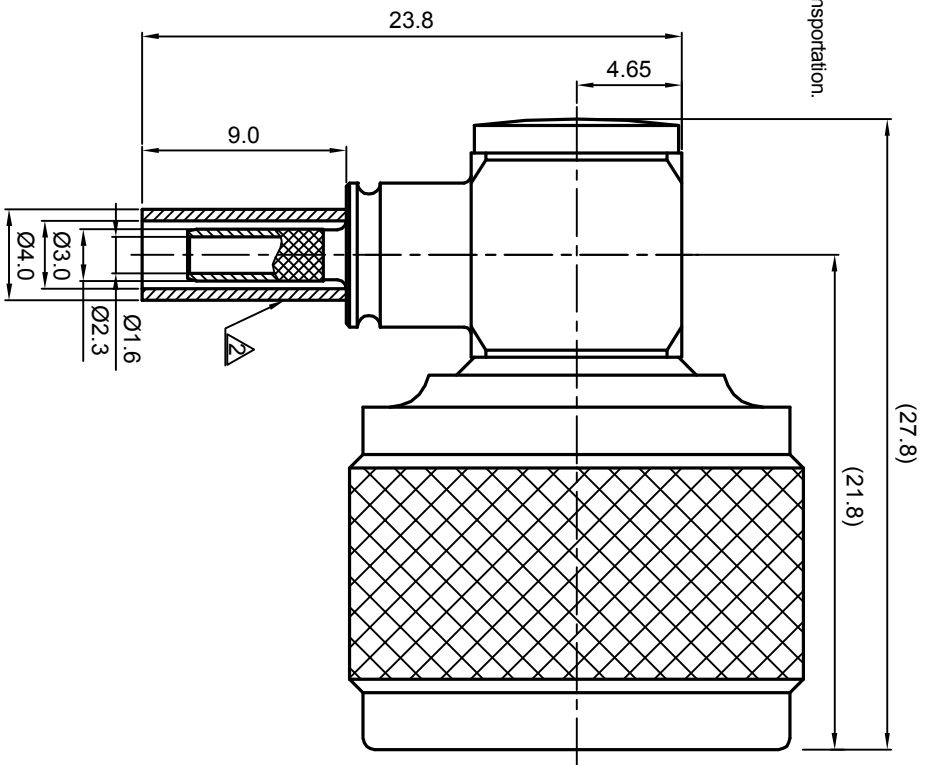

RECOMMENDED CABLE STRIPPING DIMENSIONS

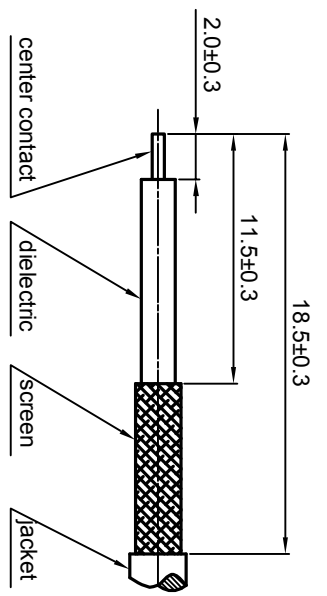

REV.	DESCRIPTION	APPROVED	DATE	EON

MATERIAL	SEE BOM FOR DETAILS
FINISH	SEE BOM FOR DETAILS
	Plating part to be touched by gloves
	Dimension apply before plating
	XXX - measuring point for plating
SURFACE	VOLUME

TOLERANCES	Oplace X ±1 1place X ±0.1 2place XX ±0.05 Angle ±5°
Remove burrs and sharp edges	

THIRD ANGLE PROJECTION	
GENERAL ECCENTRICITY	$\sqrt{0.06}$
DRAWN BY	NAME DATE
Danny.D	21Nov07
CHECKED BY	
APPROVED BY	

TITLE	N, PLUG, CABLE MOUNT		
DWG. NO.	5048.N.PRC.06.133		
SCALE	DO NOT SCALE DRAWING	SIZE	SHEET
3:1		A4	1 of 1
REV.	S1		

